

**PERSON SHORT PLAT**  
**KITTITAS COUNTY SHORT PLAT NO. 07-XX**  
**PORTION OF THE NE1/4, SEC. 4, T.19N., R.16E., W.M.**  
**KITTITAS COUNTY, WASHINGTON**

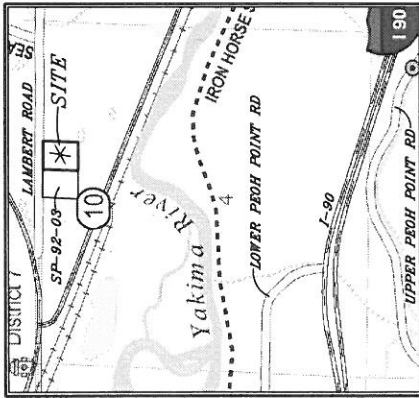

VICINITY MAP  
 N.T.S.

**APPROVALS**

KITTITAS COUNTY PUBLIC WORKS

EXAMINED AND APPROVED This \_\_\_ day of \_\_\_\_\_ A.D., 20\_\_\_

Kittitas County Engineer

COUNTY PLANNING DIRECTOR

I hereby certify that the "PERSON" Short Plat has been examined and approved in accordance with the comprehensive plan of the Kittitas County Planning Commission.

Dated this \_\_\_ day of \_\_\_\_\_ A.D., 20\_\_\_

Kittitas County Planning Director

KITTITAS COUNTY HEALTH DEPARTMENT

Preliminary inspection indicated soil conditions may allow use of septic tanks as a temporary means of sewage disposal for some, but not necessarily all, building sites within this short plat. The health department is hereby notified to make inquiries at the County Health Department about issuance of septic tank permits for lots.

Dated this \_\_\_ day of \_\_\_\_\_ A.D., 20\_\_\_

Kittitas County Health Officer

CERTIFICATE OF COUNTY TREASURER

I hereby certify that the taxes and assessments are paid for the preceding years and for this year in which the plat is now to be filed.

Dated this \_\_\_ day of \_\_\_\_\_ A.D., 20\_\_\_

Kittitas County Treasurer

**SURVEY NOTES:**

1. THE PURPOSE OF THIS DOCUMENT IS TO SHORT PLAT LOT 2 OF THAT CERTAIN SURVEY AS RECORDED BY CRUSE & NELSON FILED UNDER AUDITOR'S FILE NUMBER 563461, BOOK D OF SHORT PLATS, PAGES 69 & 70.
2. KITTITAS COUNTY RELIES ON ITS RECORD THAT A SUPPLY OF POTABLE WATER EXISTS. THE APPROVAL OF THIS DIVISION OF LAND INCLUDES GUARANTEE OF DISTURBANCE FROM PERHAPS LEGAL RIGHTS TO WITHDRAW GROUNDWATER WITHIN THE LAND DIVISION.
3. A CRITICAL AREAS REPORT FOR THIS PROJECT WAS PREPARED BY SEWALL WETLAND CONSULTING, INC. ON APRIL 4, 2007 AND IS ON FILE AT KITTITAS COUNTY COMMUNITY DEVELOPMENT SERVICES.

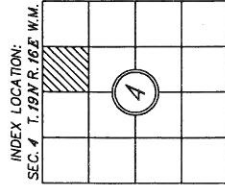

RECORDER'S CERTIFICATE

Filed for record this \_\_\_ day of \_\_\_\_\_, 20\_\_\_ at \_\_\_\_\_ M in book \_\_\_\_\_ of \_\_\_\_\_ at the request of

DAVID P. NELSON  
 Surveyor's Name

County Auditor \_\_\_\_\_ Deputy County Auditor \_\_\_\_\_

SURVEYOR'S CERTIFICATE

This map correctly represents a survey made by me or under my direction in conformance with the requirements of the Survey Recording Act at the request of... KIM & SHIRLEY PERSON in... JAN... 2007.

DAVID P. NELSON "DATE"  
 Certificate No. 18092

**K.C.S.P. NO. 07-XX**  
**Portion of the NE1/4, Sec. 4 T.19N., R.16E., W.M.**  
**Kittitas County, Washington**

DWN BY **G. WEISER** DATE **04/07** JOB NO. **07001**

CHKD BY **D. NELSON** SCALE **1"=100'** SHEET **1 OF 2**



**LEGEND**

- SECTION CORNER
- FND REBAR
- SET 1/2" REBAR LS# 18092
- A QUARTER CORNER



108 EAST 2ND STREET  
 CLE ELUM, WA 98922  
 PHONE: (509) 674-7433  
 FAX: (509) 674-7419